

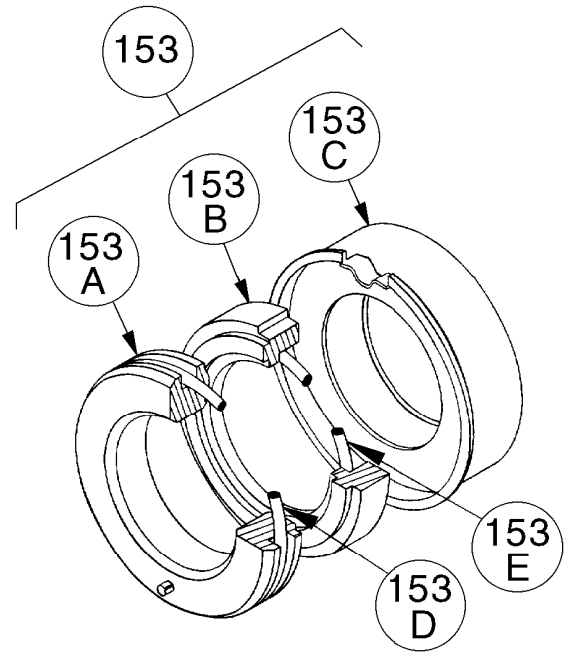

**MECHANICAL SEALS**

Ref. No.	Part Name	Parts Per Pump	Part No.
153	Mechanical Seal Complete – (Std.) Hardened Steel Stationary Seat, Carbon Seal Face, FKM O-Rings. (SVCV)	2	1 335129
	Mechanical Seal Complete – Hardened Steel Stationary Seat, PTFE O-Ring, Carbon Seal Face w/PTFE Seal Ring. (SACT)		335175
	Mechanical Seal Complete – Silicon Carbide Stationary Seat, PTFE O-Ring, Carbon Seal Face w/PTFE Seal Ring. (LACT)		335299
	Mechanical Seal Complete – Silicon Carbide Stationary Seat, Carbon Seal Face, FKM O-Rings. (LVCV)		335298
	Mechanical Seal Complete – Hardened Steel Stationary Seat, Carbon Seal Face, Buna O-Rings. (SNCN)		335225
153A#	Stationary Seat (Hardened Steel) Stationary Seat (Silicon Carbide)	2	335126 335141
153B#	Rotating Seal Face (Carbon)	2	331867
153C#	Jacket Assembly	2	335128
153D	O-Ring – Stationary (FKM)	2	702015
	O-Ring – Stationary (PTFE)		711999
	O-Ring – Stationary (Buna)		702025
153E	O-Ring – Rotating (FKM)	2	701962
	Seal Ring – Rotating (PTFE)		701963
	O-Ring – Rotating (Buna)		711912



<sup>1</sup> Included in Maintenance Kit and Rebuild Kit

# These components are included in the complete mechanical seal assemblies (Ref. No. 153), and are NOT available as replacement parts. Consult factory.

**FLANGE OPTIONS**

Ref. No.	Part Name	Parts Per Pump	Size 3 Part No.
42	Flange - NPT	1-2	655112
	Flange - Weld		655102
	Flange – ANSI 3" 150 lb. R.F.		651817
42C	O-Ring Flange (FKM) (Std)	2	<sup>1</sup> 711931
	O-Ring - Flange (PTFE)		702080
	O-Ring - Flange (Buna)		702002
42B	Capscrew- NPT Flange	8	920547
	Capscrew – Weld/ANSI Flg		920510

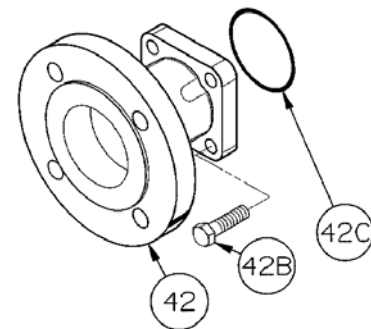
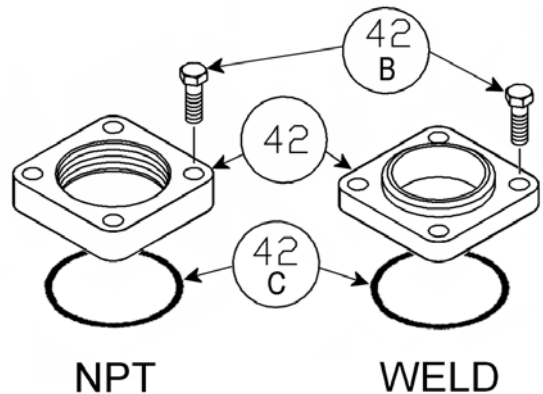

ANSI FLANGE

