

BLACKMER PUMP PARTS LIST

MODELS: PLW(J)2B, PLW(J)3B

DISCONTINUED MODELS: PLW(J)2A, PLW(J)3A

NOTE: "B" model suffix indicates Viton replaces Buna-N as the standard elastomer.
(See Instructions 185/MM for Installation, Operation and Maintenance)

963911
PARTS LIST NO. 185/M7

Section	100
Effective	June 1995
Replaces	April 1990

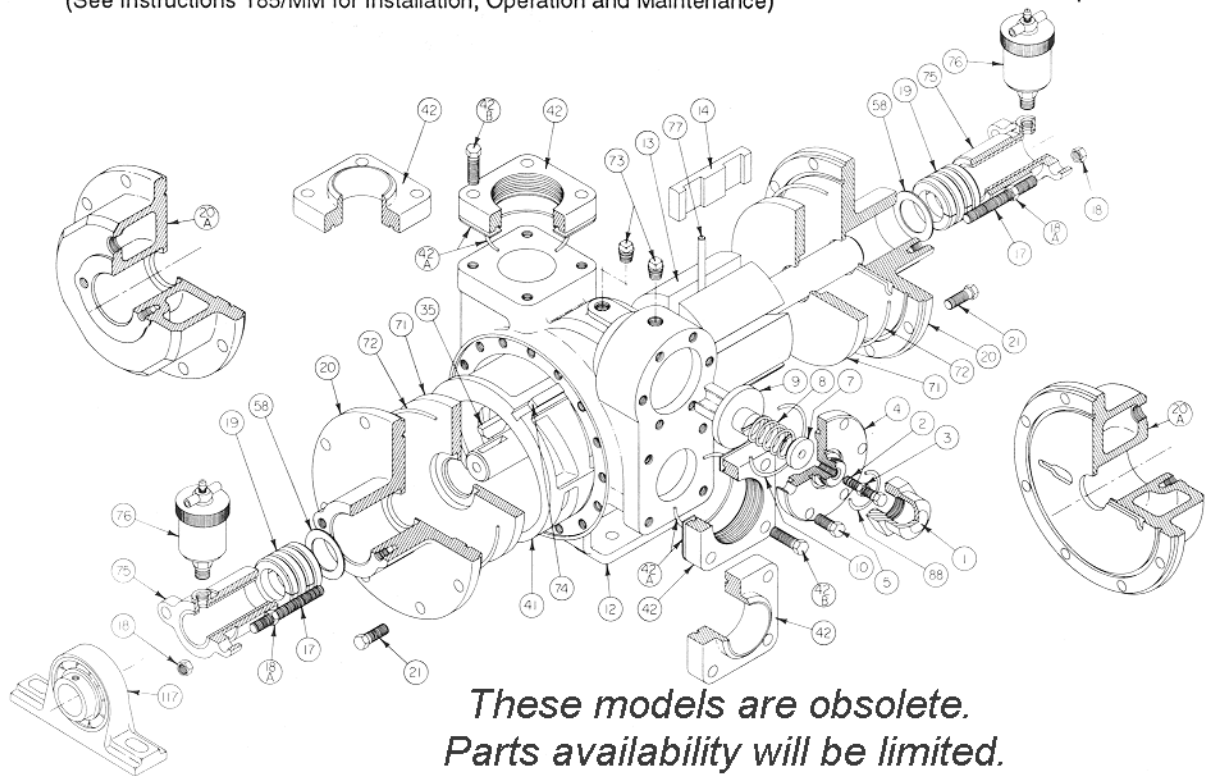

REF. NO.	PART NAME	PARTS PER PUMP	SIZE 2 PART NO.	SIZE 3 PART NO.	REF. NO.	PART NAME	PARTS PER PUMP	SIZE 2 PART NO.	SIZE 3 PART NO.			
1	Cap - Relief Valve (R/V)	1	414402	414402	20A	Jacketed Head (Std. - PLWJ)	2	034435	035135			
2	Adjusting Screw - R/V	1	433905	431808	21	Capscrews - Head	16 - 20	920331	920351			
3	Locknut - Adjusting Screw	1	922923	922923		Capscrews - Jacketed Head		920331	920369			
4	Cover - R/V	1	414408	415112	35	Key - Shaft	1	909130	909135			
5	Capscrew - R/V Cover	6	920316	920331	41	Liner	1	183913	185116			
7	Spring Guide - R/V	1	424401	423955	42	Flange - NPT	2	654401	655112			
8	Spring - R/V (35 - 50 psi) (Std. - PLWJ)	1	471420	471608		Flange - Weld		654405	655102			
	Spring - R/V (51 - 75 psi)		471425	471612	42A	O-Ring - Flange (Viton) (Std.)	702086#	711931#				
	Spring - R/V (76 - 110 psi)*		471428	471621		O-Ring - Flange (Teflon)	702078#	702080#				
	SS Spring - R/V (35 - 50 psi) (Std. - PLWJ)		471418	471610	42B	Capscrew - NPT Flange	920384	920547				
	SS Spring - R/V (51 - 75 psi)		471427	471632		Capscrew - Weld Flange	920351	920510				
SS Spring - R/V (76 - 110 psi)*	471429	471615	9	Valve - R/V	1	454405	455129	58	Packing Washer	4	353907	355107
10	O-Ring - R/V Cover (Viton) (Std.)	1	711929#	701924#	71	Disc	2	063980	065181			
	O-Ring - R/V Cover (Teflon)		702077#	702079#	72	O-Ring - Head (Viton) (Std.)	2	702045#	711938			
12	Casing	1	014405	015127		O-Ring - Head (Teflon)	702081#	702082#				
13	EC Rotor & Shaft Assy. (Std.)	1	264427	265227	73	Gage Plug	2 - 4	908195	908195			
	EC Rotor & Shaft Assy. (V-Belt Length)		264428	265228	74	Key - Liner	1	184407	185191			
14	Vane - Hardened Iron	6	093930	095127	75	Gland Bearing (Std. - PLW)	2	143909	145109			
	Vane - EC Hard. Iron (Std.)		093931	095129	Gland Bearing (Std. - PLWJ)	143910	145110					
	Vane - Laminate		091427	095109	76	Automatic Lubricator	2	317880	317880			
	Vane - EC Laminate		091429	095107	77	Push Rod	3	123905	125105			
	Vane - Bronze		093922	095116	88	O-Ring - R/V Cap (Viton) (Std.)	1	701979#	701979#			
Vane - EC Bronze	093924	095120	O-Ring - R/V Cap (Teflon)	702075#		702075#						
17	Stud - Gland	4	921475	921475	117	Pillow Block	1	903737	903736			
18A	Removal Nut - Gland	4	922949	922949								
19	Packing Set	2	323976	325176								
20	Head (Std. - PLW)	2	034434	035134								

* R/V spring range (p/n 471428 & 471429) for 2-inch models is 76 - 90 psi.
SS = Stainless steel spring for temperatures over 300°F (149°C).

Recommended spare parts.

EC = Extra Clearance